

Proposed Use Of Building

NOTE Maximum Shed Area: 625 sq ft (58m²)
 Maximum Shed Height: 19.7ft (6m) to peak

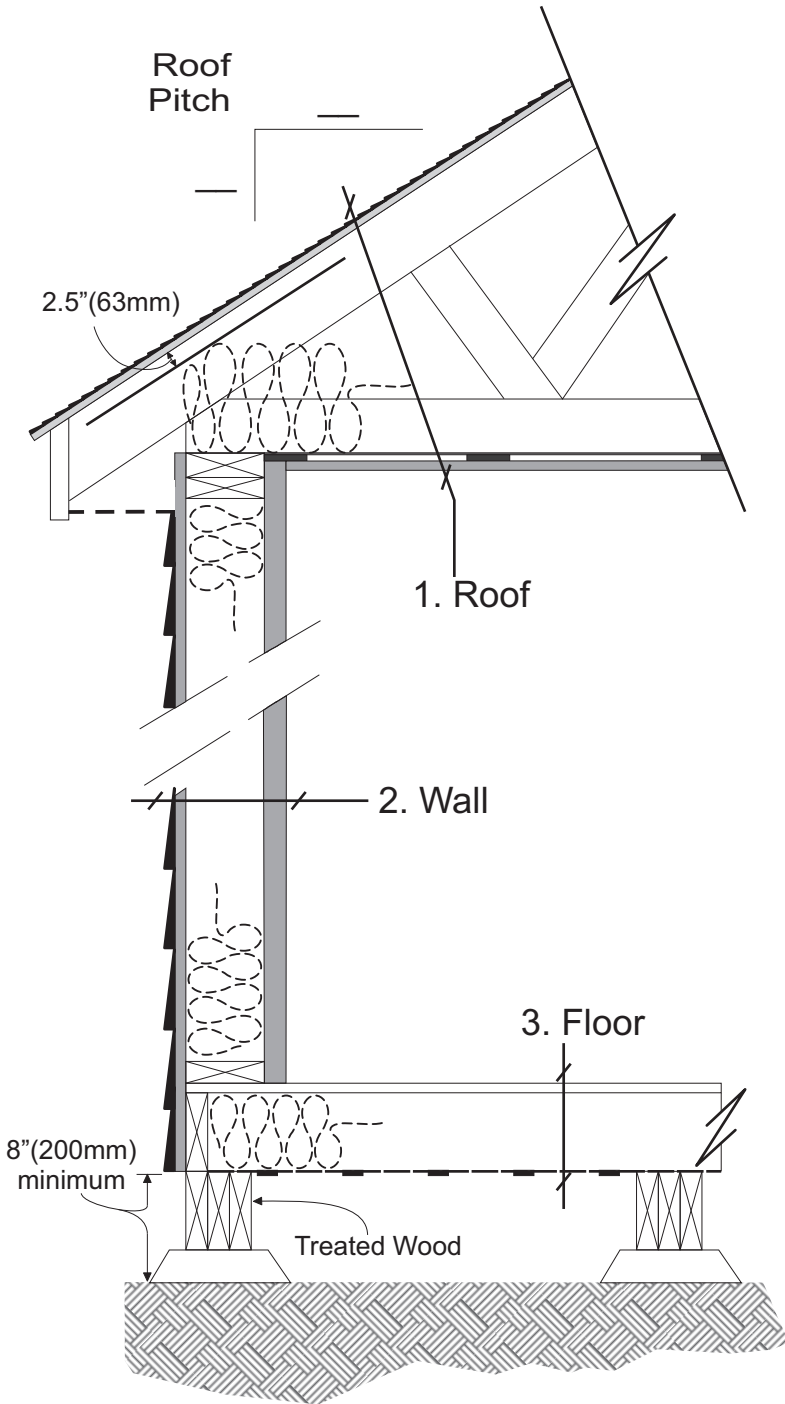

**** NOT TO SCALE ****

Show Location & Size Of Openings For Windows & Doors On Building Plan

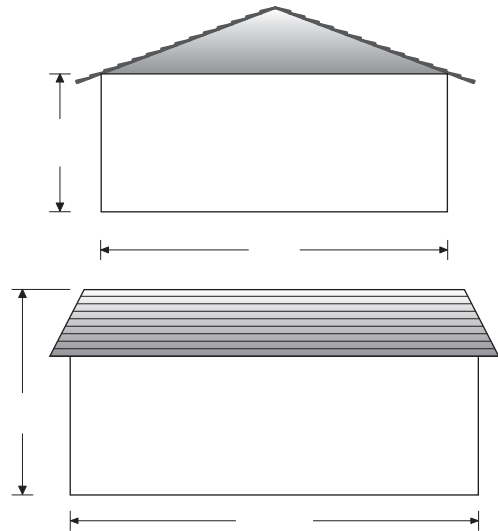

1. Roof

Roofing Type: _____

Sheathing Type & Thickness: _____

Truss: - Engineered
 - Fabricated
 - Rafter

- Member Size / Grade: _____

- Spacing: _____

Insulation (Type & R-Value): _____

Strapping (Type, Size & Spacing): _____

Vapour Barrier (Type & Thickness): _____

Ceiling Finish (Type & Thickness): _____

2. Wall

Exterior Cladding (type): _____

Air Barrier (type): _____

Sheathing (Type & Thickness): _____

Stud Size & Spacing: _____

Insulation (Type & R-Value): _____

Vapour Barrier (Type & Thickness): _____

Finish (Type & Thickness): _____

3. Floor

Sub-floor (Type & Thickness): _____

Vapour Barrier (Type & Thickness): _____

Insulation (Type & R-Value): _____

Joist Size & Spacing: _____

Moisture Barrier: _____

Beam Spacing & Size (3 @): _____

City of Moncton - Building Inspection Department

Detached Shed - Single Family (typical)

Permit Application Number: _____

Owner / Agent Signature: _____

Telephone Number: _____

Street Address: _____

Date: _____

Received By: _____

